

SHUN KUANG



SK AIR CIRCULATOR

User's Guide

PATENTS : M300023
M335574

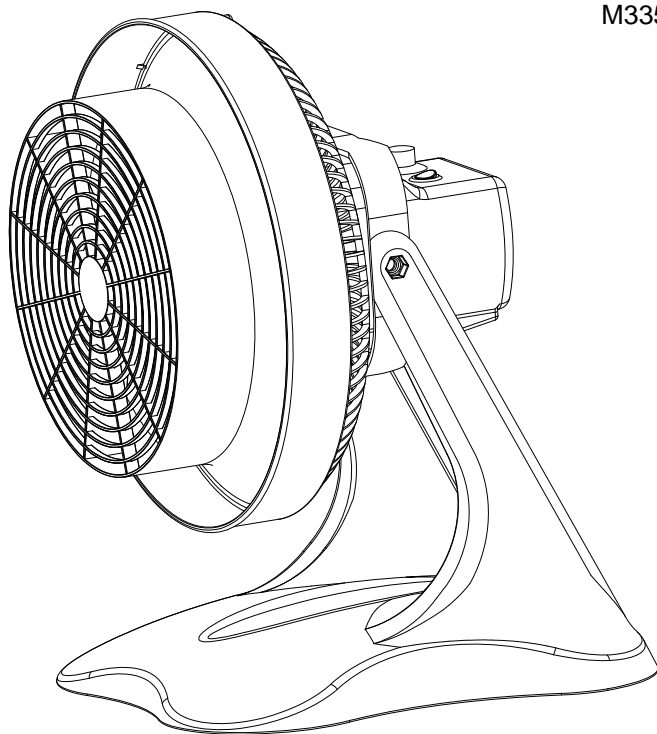

JF 250GH

JF 300GH

WARNING: To reduce the risk of fire or electric shock, do not use this product with any solid-state speed control device.

IMPORTANT SAFETY INSTRUCTIONS

When using electrical appliances, basic precautions should be complied with the following instructions to avoid the risk of fire, electric shock or injury to persons happening.

1. This air circulator has a polarized plug (one blade is wider than the other). To reduce the risk of shock, this plug is intended to fit only one way in a polarized outlet. If the plug does not fit fully in the outlet, reverse the plug. If it still does not fit, contact a qualified electrician. Do not attempt to defeat this safety feature.
2. Do not use near high-temperature, high-humidity, stoves, furnaces, or other heat sources.
3. This product is intended for household use and not for outdoor use.
4. Do not immerse this product in water or spray with liquids to drip into the motor housing.
5. Do not use acid/alkali oil, gasoline, or other chemicals for cleaning.
6. Do not place this product in a bathtub or shower.
7. Do not near the drapes so as to inbreathe the motor occur.
8. First turn the power switch off position before pulling out the plug. And check your voltage specification to match the indication rule.
9. Do not use wet hand pull out the plug to occur the damage of electrical shock.

10. Do not operate the product before assembling completely.
11. Do not put the clothing over the fan net.
12. Do not allow the finger & incisive goods to insert the fan net, especially for children.
13. Do not spray volatility liquid or insecticide to occur the damage of the body.
14. Please contact an authorized service facility for examination or repair if there is any fuse loose to cause a short circuit happened.

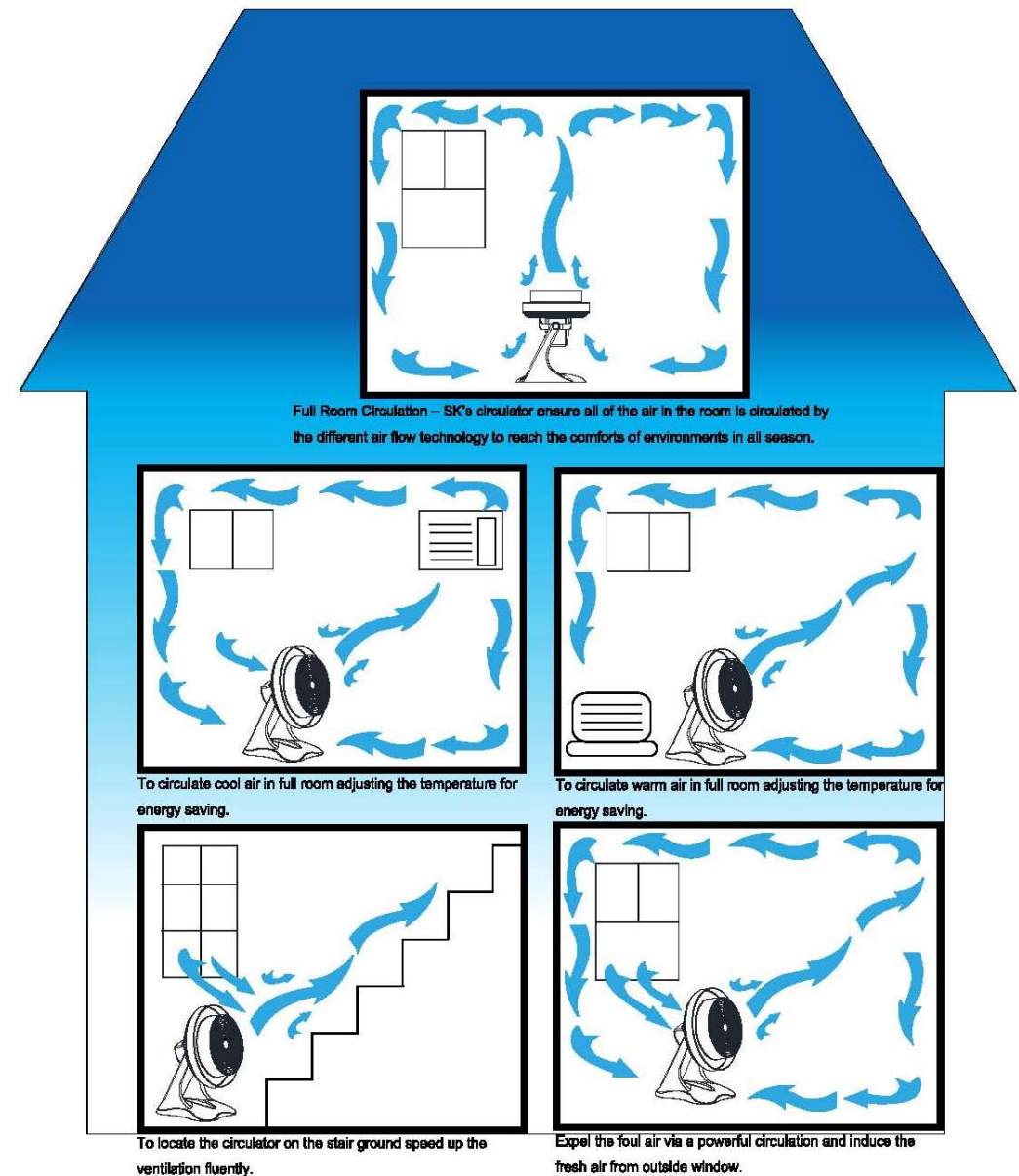

The "Induced Motion" in all room circulation.



AFTER

BEFORE

A full-room air circulator will improve heat and cool distribution from heating and cooling systems.

By circulating the warm or cool air, you can keep a more even temperature and make your home comfortable.

SK's air circulator will improve air motion through the room, therefore less cooled or warm air for the energy saving in the same space.

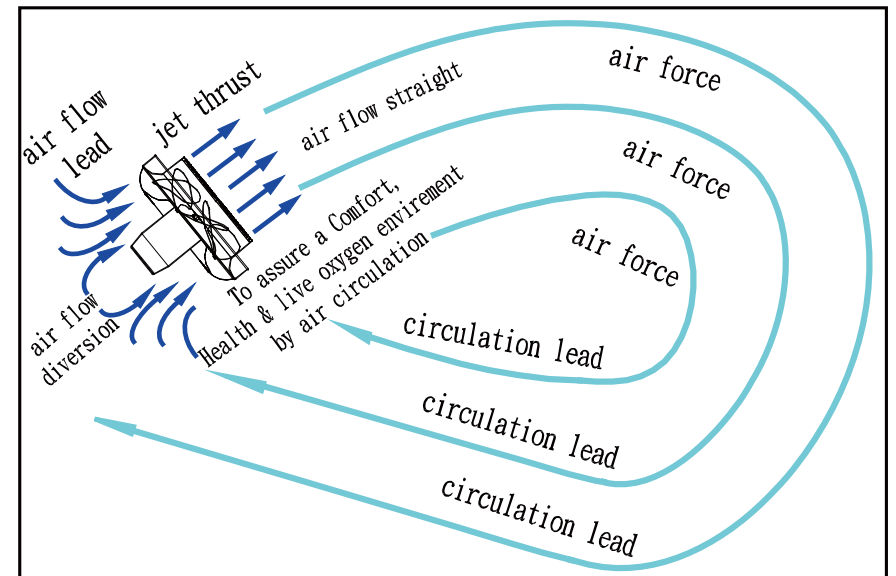
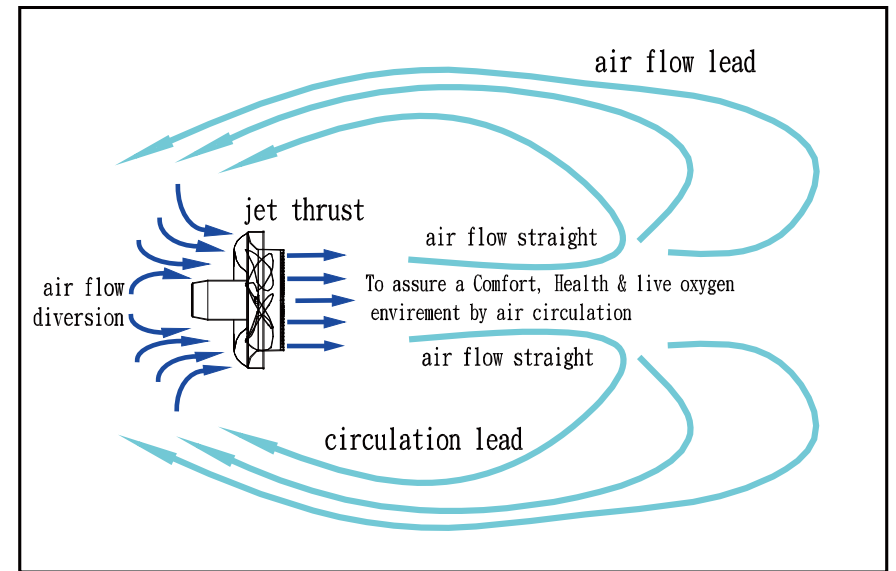

Unlike ordinary fans, SK innovate the full room circulation using a new patents of air flow technology called "Induced motion". The air will be flowed by the different motion of rectification, jet, and diversion creating convection, circulation increasing the live oxygen efficiency.

MODEL		JF-250GH	JF-300GH
NAME		PREMIUM AIR CIRCULATOR 10"	PREMIUM AIR CIRCULATOR 12"
FEATURE	32 degree angle horizontal oscillation	✓	✓
	105 degree angle vertical pivoting	✓	✓
	incessant air circulation in an entire room	✓	✓
	Moves air above 60 feet over	✓	✓
	Low noise during the running process	✓	✓
	Lower Energy Costs by all season	✓	✓
	Breeze/Sleep mode options	✓	✓
DESCRIPTION	Powerful and quiet: New blade patent design moves air to enlarge flowing space with less noise than the typical .	✓	✓
	Diversion and convection: High performance synchronous motor accelerate the air to ensure the air travels long distances.	✓	✓
	Saves energy and rapid circulation: SK air circulator can help you save money using a whole-room circulation along with cooling or heating system by adjusting temperature indoor year-round .	✓	✓
	Easy to clean and disassemble: A detachable grill is taking simply for the blades cleaning on maintaining.	✓	✓
SPECIFICATION	Air Moved	60 ft. over	70 ft. over
	Depth	14.96"	14.96"
	Height	19.69"	20.67"
	Grill Diameter	14.17"	16.54"
	Speeds	3	3
	Amps	0.24/0.2/0.15	0.46/0.39/0.32
	Watts	26/23/17	63/56/49
	Warranty	1 Year	1 Year
	Color	WHITE	White
	Net Weight	8.6lbs	9.3lbs
	Blade	ABS Injection	ABS Injection
	Rear/Front Grille	ABS Injection	ABS Injection
	Mount	ABS Injection	ABS Injection
APPLICATION	Residential	✓	✓
	Commercial	✓	✓

Cleaning & Maintenance Instructions:

Step 1.

Unplug the product before removing or cleaning the grilles. Rear grille aim the central hole at the fan shaft and then lock by screw nut.

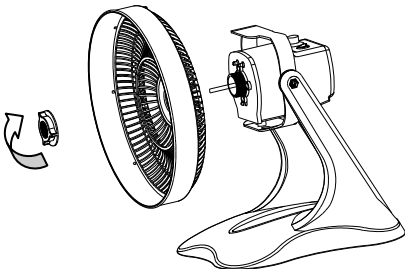

Step 2.

Real blades aim the hole at the fan shaft to be fixed. Rotate the blades counter-clockwise to unlock by fan spinner.



Note: Blades must to be aimed at an axle center.

Step 3.

Place the front grille by 15 degree angle facing you. Replace the 2 screws located in between the holes of the grilles edge at roughly 12 & 6 o'clock positions.

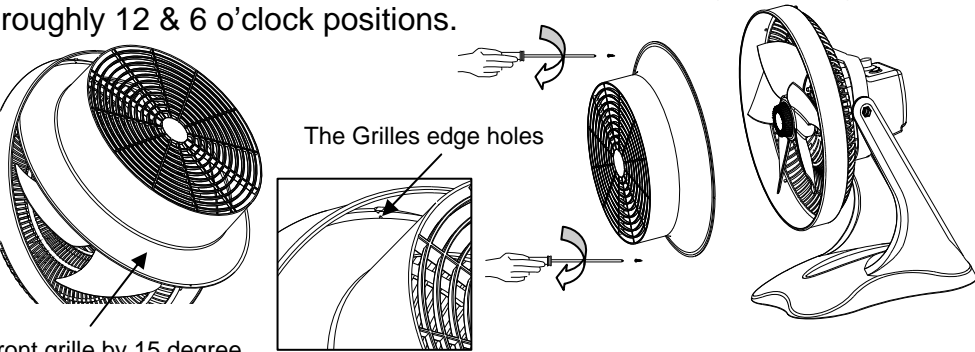

Front grille by 15 degree

How to use:

- Be sure your power cord to match the specification of wall outlet.
- A 3 speed control knob is located within easy reach on the upper back portion of the circulator.

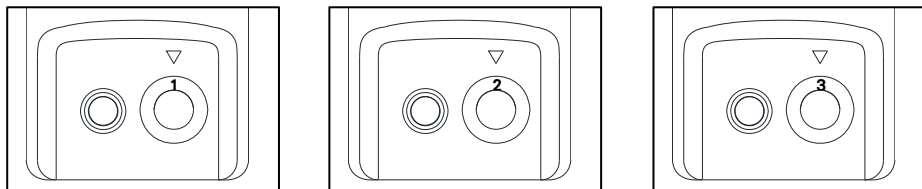

- Oscillation setting: By push-button to (•) symbol starting the horizontal oscillation.

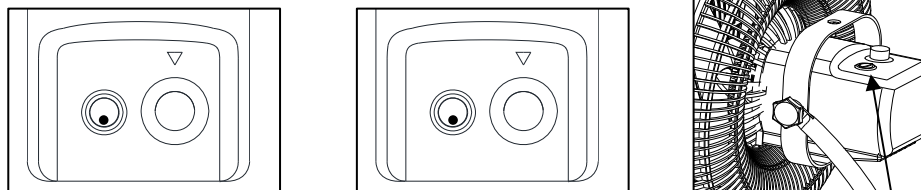

Shakes the head the switch toward under to press, shakes the head immediately

Shakes the head the switch toward not to have under the indication place to press, stops shaking the head immediately

Shakes the head the controlling switch

- Vertical pivoting: Adjustable by 15 degree downward to 90 degree upward

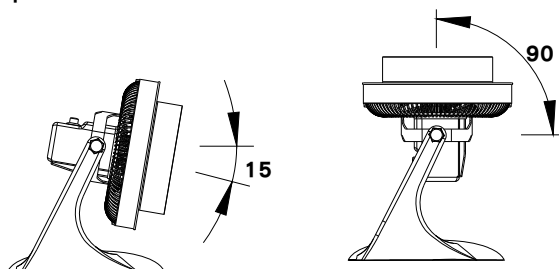

When the user adjusts to suitable needs the angle of elevation, must the anchor screw locking then.

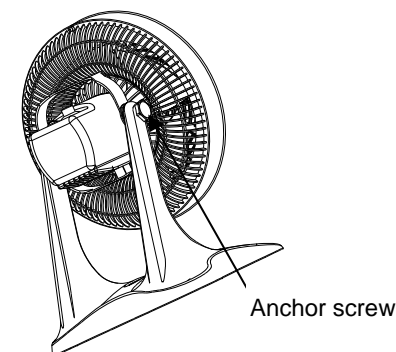

Dexterous good grasps raises the handle, the user facilitates the migration.

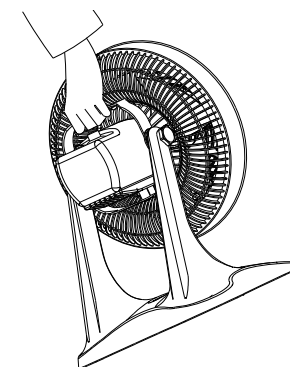

Limited Warranty:

Please contact with our local exclusive distributor for the further limitation.